

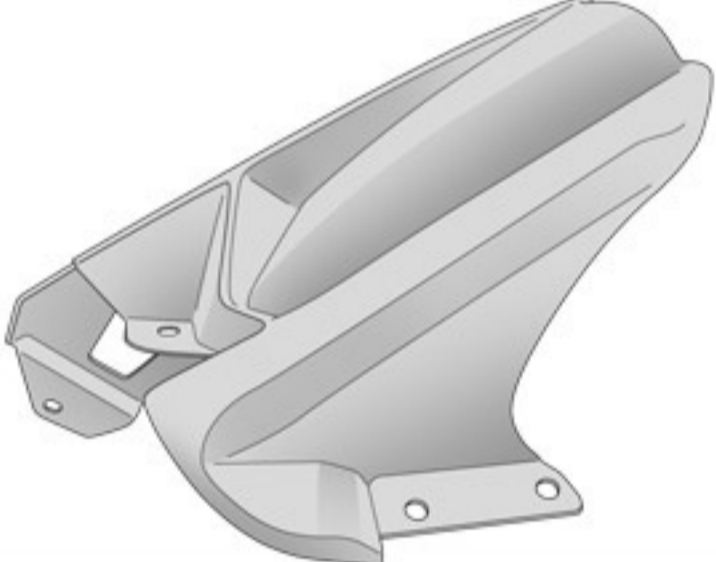











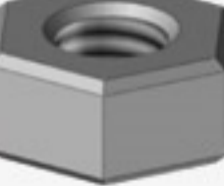

## Montage Hinterradabdeckung - Rear Hugger instructions

6580096



NR	TEILE / PARTS	MENGE	BESCHREIBUNG	DESCRIPTION
1		x1	Hinterradabdeckung	Ermix rear hugger
2		x1	Aluminium Kettenschutz	Aluminium Ermix chain guard
3		x1	<i>original Kunststoffniet</i>	<i>Original nylon insert</i>
4		x2	<i>originale Kettenschutzschraube M6 x 15</i>	<i>M6 x 15 Original chain guard screw</i>
5		x1	<i>originale Sechskantschraube M6 x 40</i>	<i>M6 x 40 Original hexagonal screw</i>
6		x2	<i>originale Schalldämpferschraube M6 x 35</i>	<i>M6 x 35 Original silencer screw</i>
7		x1	<i>originale Schalldämpferschraube M6 x 35</i>	<i>M6 x 35 Original silencer screw</i>
8		x1	<i>originale Mutter M6</i>	<i>M6 Original silencer nut</i>
9		x2	<i>originale Schraube Fussraste</i>	<i>Original platinum footrest screw</i>
10		x3	<i>originale Sechskantschraube M6 x 20</i>	<i>M6 x 20 Original hexagonal screw</i>
11		x4	Kunststoffunterlegscheibe Ø6 L10 H1	Ø6 L10 H1 Nylon washer
12		x4	Schraube M6 x 10 BHC	M6 x 10 Black BHC screw
13		x2	Gummiensatz mit M5 Gewinde	Ø5 Rubber insert
14		x2	Kunststoffunterlegscheibe Ø5 L10 H1	Ø5 L10 H1 Nylon washer
15		x2	Schraube M5 x 15 BHC	M5 x 15 Black BHC screw

### 1 Demontage - Disassembly

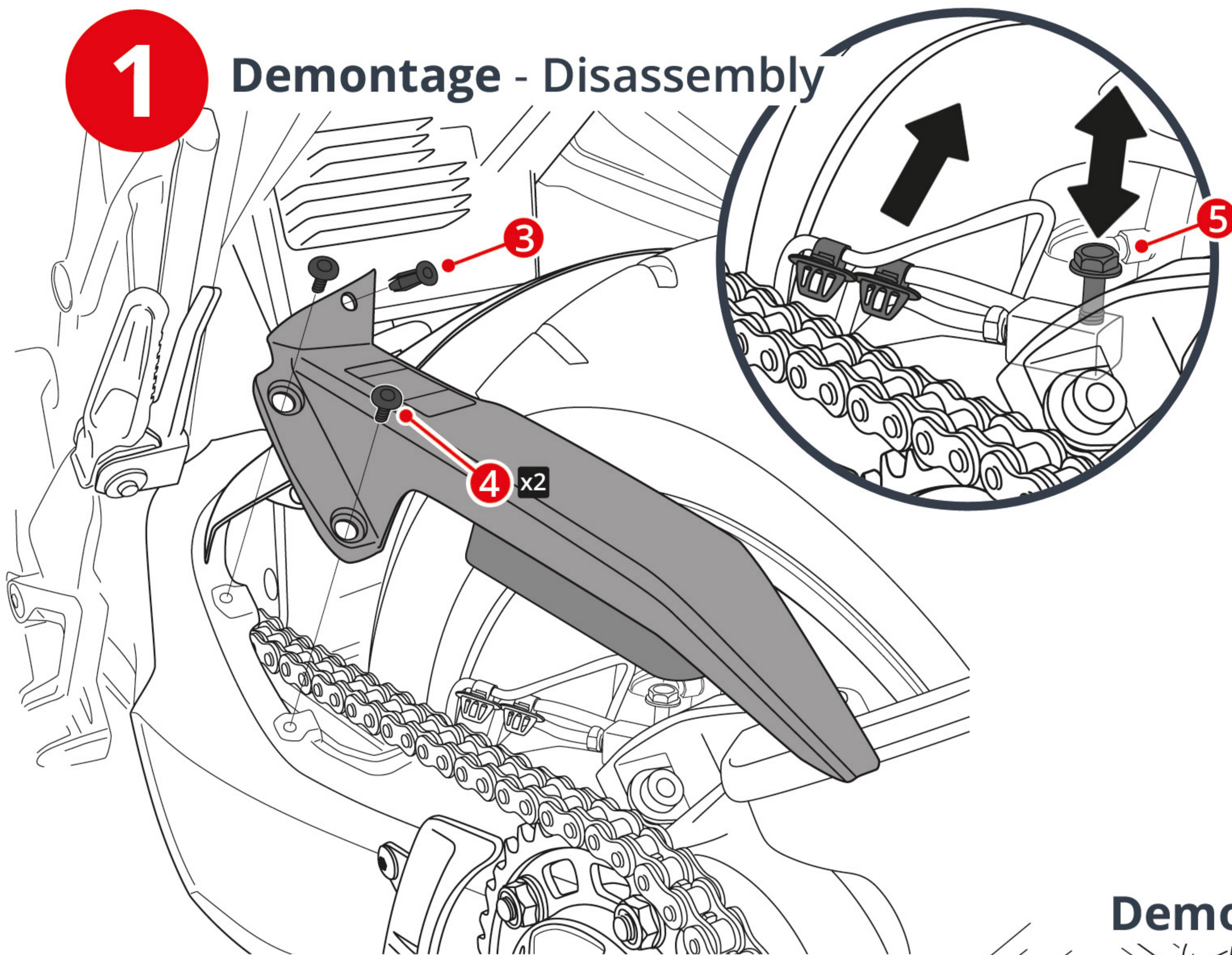

### 2 Lösen Loosen

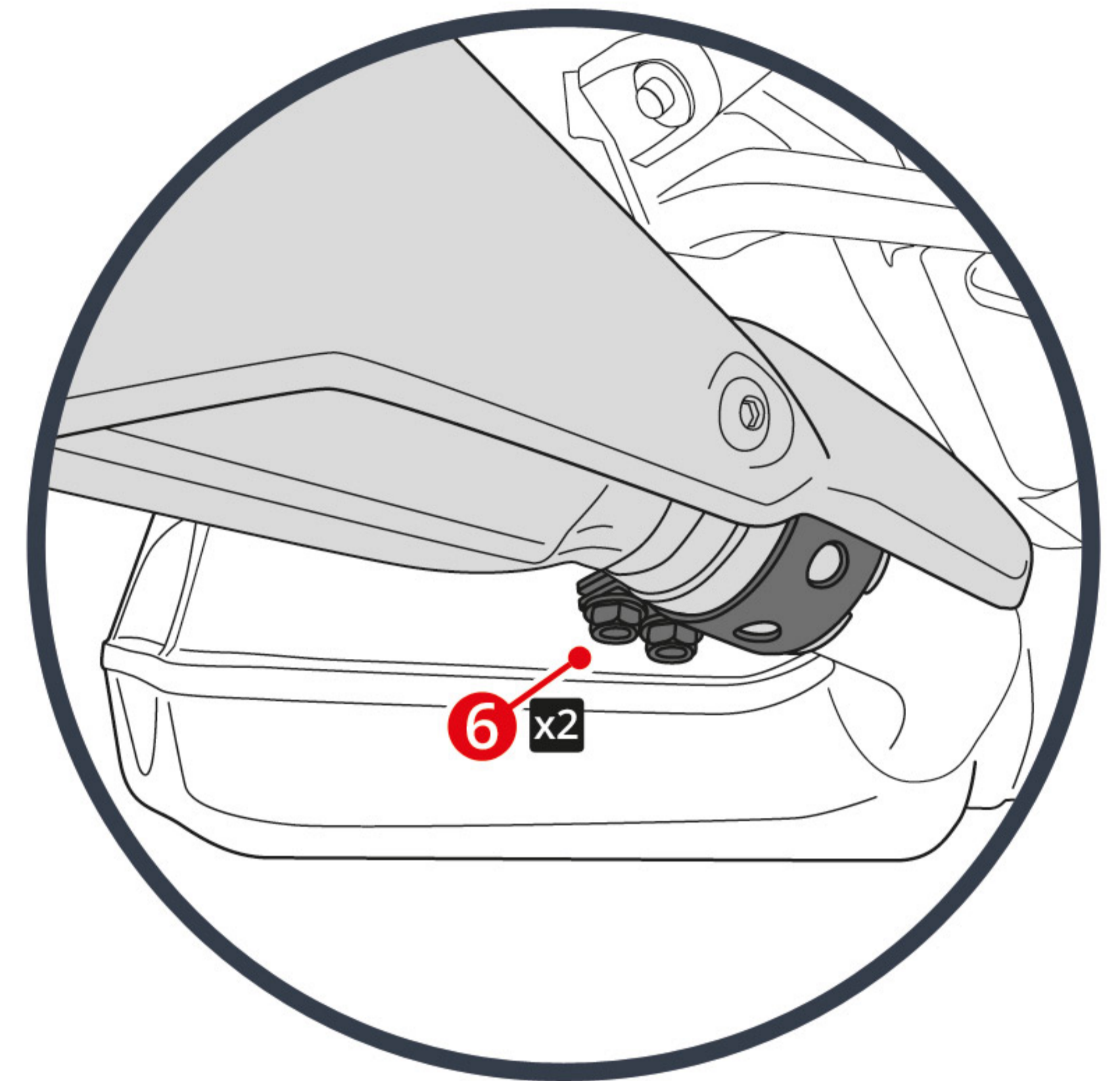

### Demontage - Disassembly

### 3

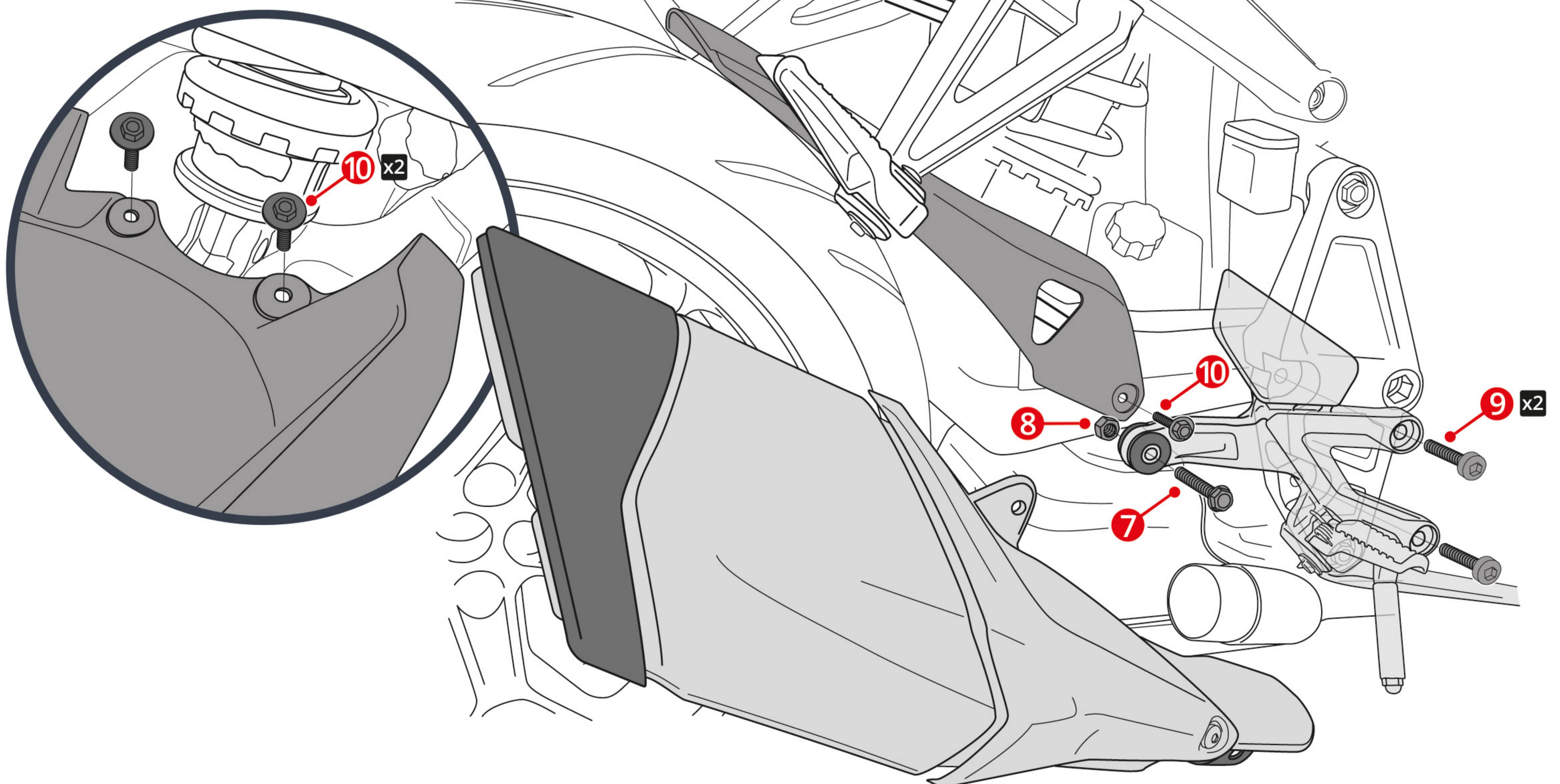

### Montage - Assembly

**4**

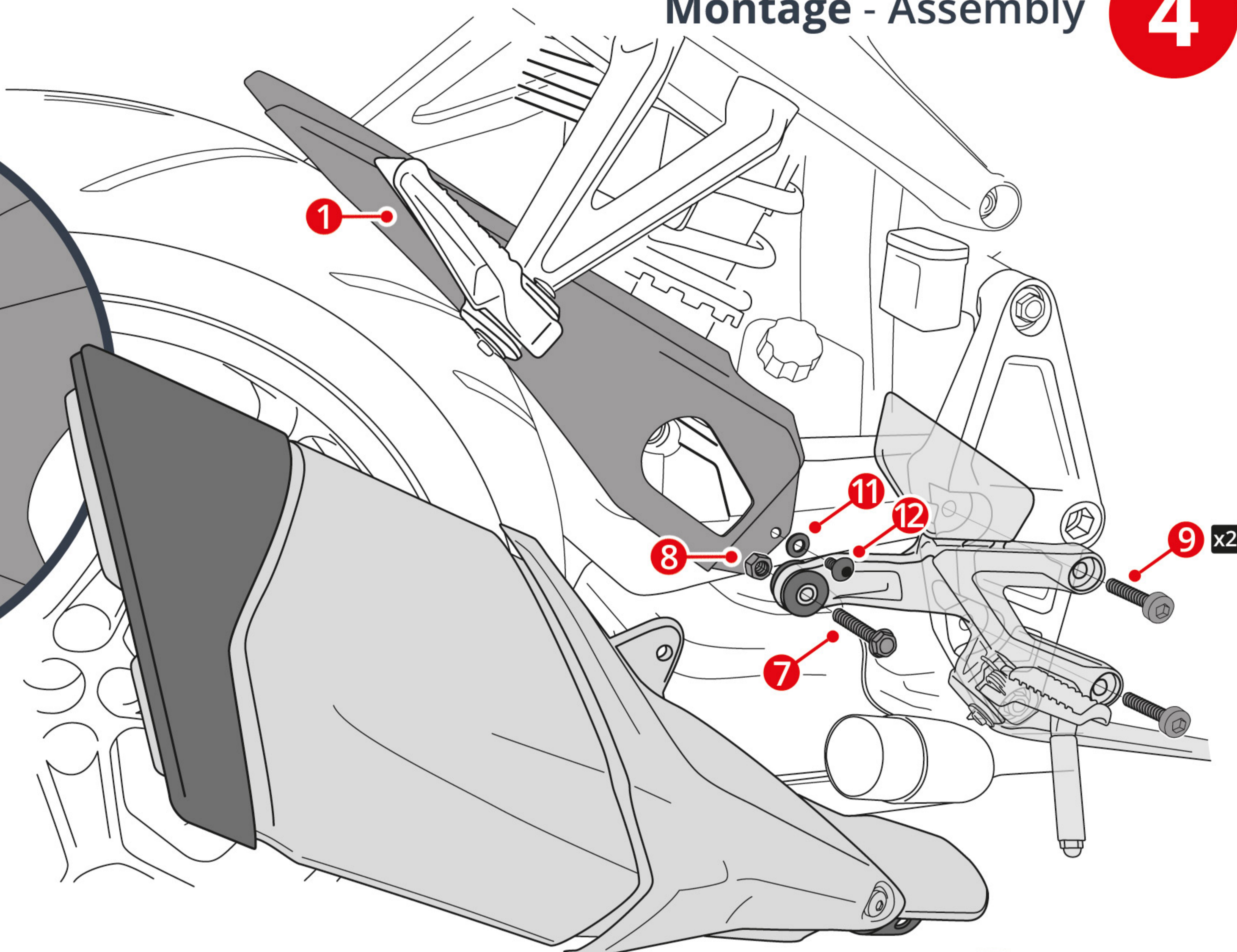
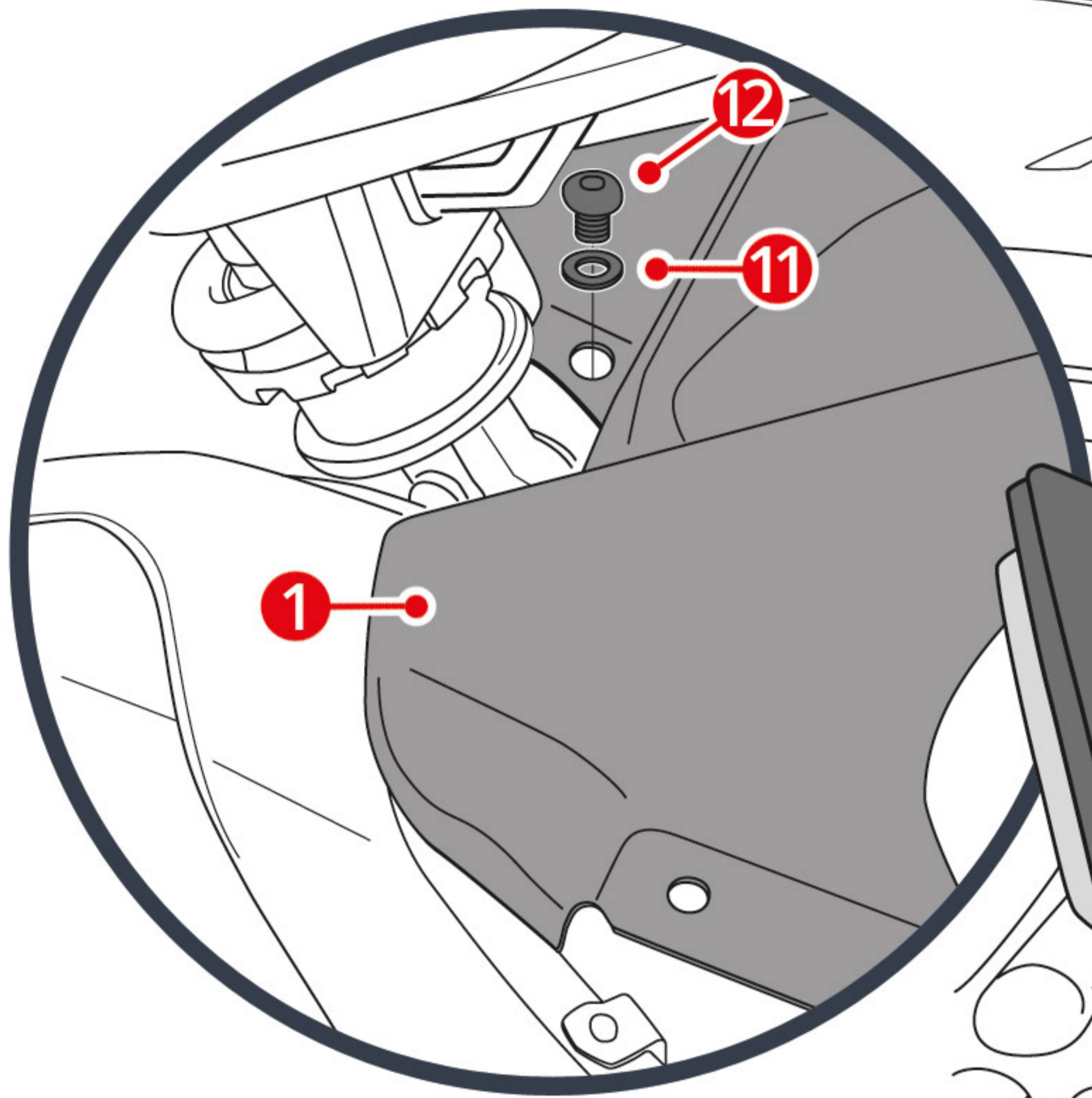

### **5** Schelle Clamp

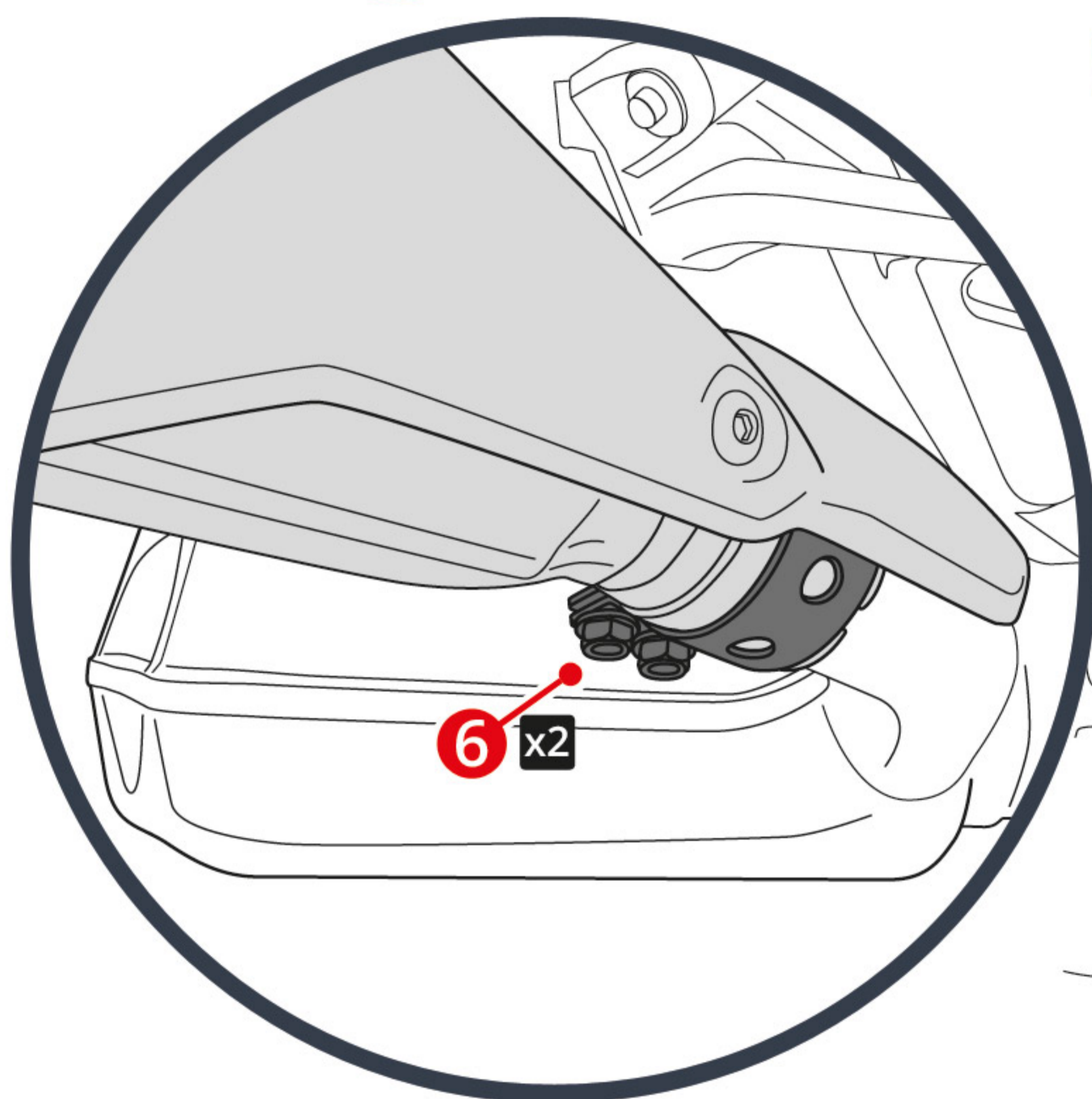

### **6** Montage - Assembly

